



AD ASTRA PER ASPERA  
**Kansas**  
Department of Transportation

**EXISTING U.S. 40 (6TH STREET) AND K-10 INTERCHANGE**

**West Lawrence U.S. 40 (6th St.)  
and K-10 Interchange Improvements**  
*Douglas County*



**ABOUT THE PROJECT**

KDOT’s West Lawrence U.S. 40 (6th Street) and K-10 Interchange Improvements Project will reconfigure the existing interchange into a diverging diamond interchange (DDI). A DDI enhances safety and mobility by reducing potential crash points at intersections and by allowing more vehicles to move through the intersection. The interchange will include a sidewalk with barriers down the center of the bridge to provide protection for pedestrians.

For more information about DDIs and the project, visit:  
**[ike.ksdot.gov/us40-k10-interchange-improvements](http://ike.ksdot.gov/us40-k10-interchange-improvements)**



In addition to this interchange improvement, work will happen on K-10 under the U.S. 40 (6th Street) bridge for the South Lawrence Trafficway (SLT) project. This project is focused on enhancing safety and mobility for the SLT Corridor and the surrounding highway system.

More information on the SLT project: **[slt-ks.ksdot.gov](http://slt-ks.ksdot.gov)**



**WHAT IS IKE?**

The Eisenhower Legacy Transportation Program—IKE—is a roughly \$10 billion investment in the future of Kansas. This program and the transportation improvements it will deliver will improve safety, modernize infrastructure and create jobs across Kansas.

**Open for details about traffic improvements coming to your area!**

**Project Contact Information**

Kate Craft	Public Affairs Manager	785-296-0192	kate.craft@ks.gov
Greg Gonzales	Project Manager	785-368-8293	greg.gonzales@ks.gov

This information can be made available in alternative languages and accessible formats upon request. Contact the KDOT Division of Communications by dialing 785-296-3585 for voice. Dial 711 for speech/hearing impaired.



Kansas Department of Transportation  
Division of Communication  
700 SW Harrison, 2nd Fl. West  
Topeka, KS 66603-3754



## PROJECT CONSTRUCTION IS UNDERWAY

The West Lawrence U.S. 40 (6th Street) and K-10 Interchange Improvements Project includes multiple enhancements to transform the interchange into the western gateway of Lawrence that will benefit drivers, pedestrians and cyclists. The work, which is already underway, is expected to be completed by the end of 2024. This is the first diverging diamond interchange (DDI) to be constructed in Lawrence. The closest open DDI is in Olathe at K-10 and Ridgeview Road.

KDOT is working to deliver this project in phases to reduce the amount of time the interchange will be closed to traffic. The following graphic highlights the three planned phases.

### Happening now!

U.S. 40 between E. 800 and E. 900 Roads is closed for the duration of the project.

## DIVERGING DIAMOND INTERCHANGE (DDI) BENEFITS

The DDI is a design innovation that improves safety and mobility, often at a much lower cost, compared to conventional interchange designs. The benefits include:

- Safe and convenient bridge crossings for pedestrians and cyclists.
- Traffic signals that can be activated by pedestrians and cyclists.
- Sidewalk with barriers to cross the bridge.

More information on DDI benefits can be found on the Federal Highway Administration's DDI handout using the QR code.

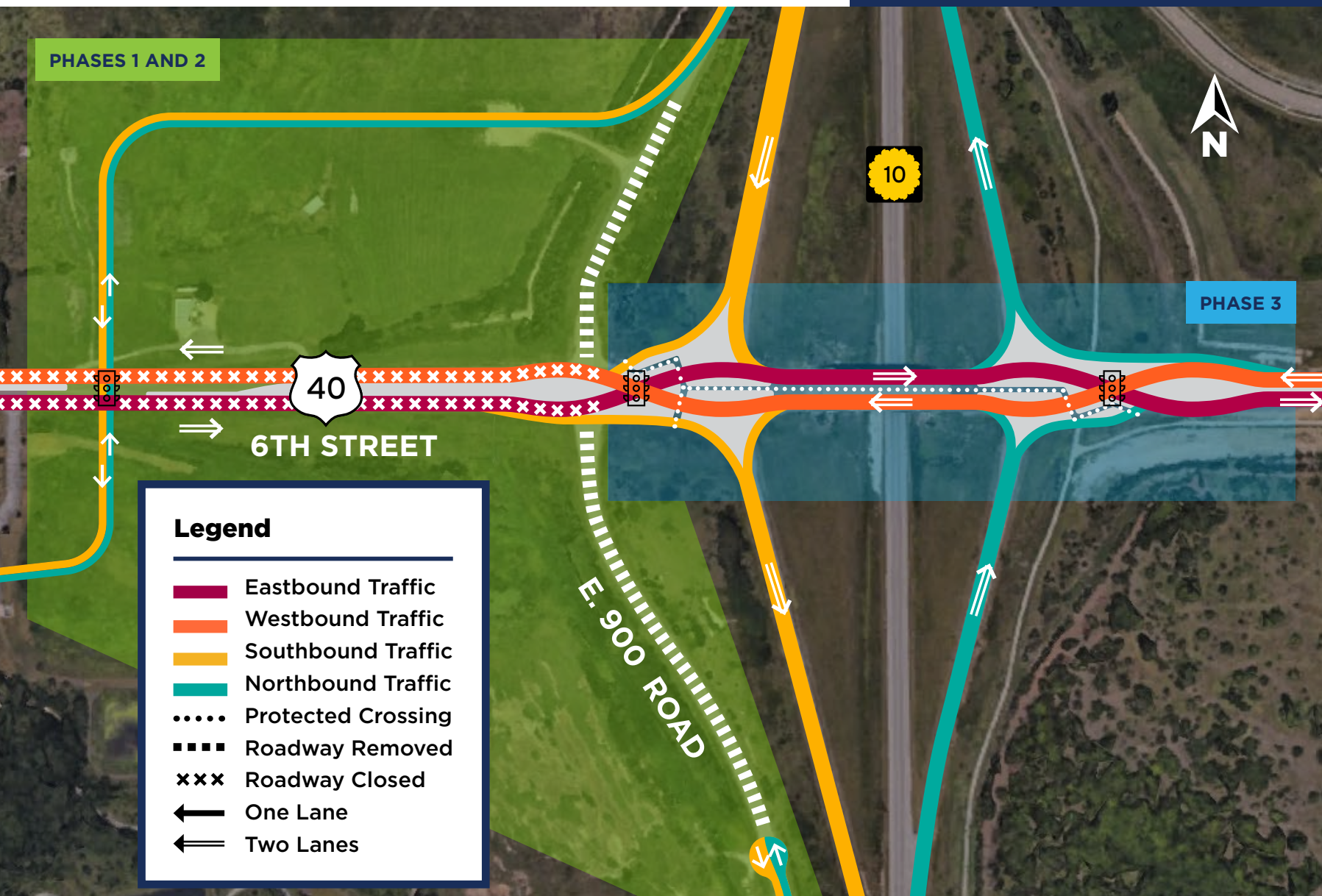

### PHASES 1 & 2 Improving Local Connections Spring 2024

- Local access remains open.
- E. 900 Road connection north of U.S. 40 reconstructed and shifted west.
- E. 900 Road south of U.S. 40 closed. Cul-de-sac constructed for local traffic.

### PHASE 3 Interchange Improvements Summer 2024

- Full interchange closure.
- Expected completion end of 2024.
- K-10 and U.S. 40 ramps redesigned and rebuilt to create diverging diamond interchange.